

SAE HALF COUPLINGS - Shoulder

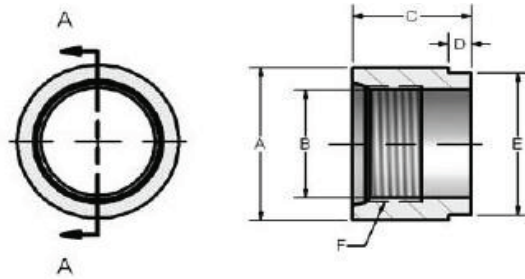

SAE HALF COUPLING						
PART NO.	A	B	C	D	E	F SAE UN-2B
TR-835-04	0.88	0.389	1.00	0.250	0.750	7/16-20*
TR-835-06	1.00	0.508	1.00	0.250	0.875	9/16-18*
TR-835-08	1.25	0.689	1.06	0.250	1.125	3/4-16*
TR-835-10	1.38	0.806	1.06	0.250	1.250	7/8-14*
TR-835-12	1.50	0.981	1.28	0.250	1.375	1 1/16-12
TR-835-14	1.63	1.106	1.25	0.250	1.500	1 3/16-12
TR-835-16	1.75	1.231	1.28	0.250	1.625	1 5/16-12
TR-835-20	2.25	1.544	1.28	0.250	2.125	1 5/8-12
TR-835-24	2.75	1.794	1.28	0.250	2.500	1 7/8-12
TR-835-32	3.25	2.419	1.50	0.250	3.000	2 1/2-12

*UNF-2B

- AISI1020 Carbon Steel
- Includes individual thread identification marking
- Additional thread sizes and configurations available

SAE HALF COUPLINGS - BEVEL

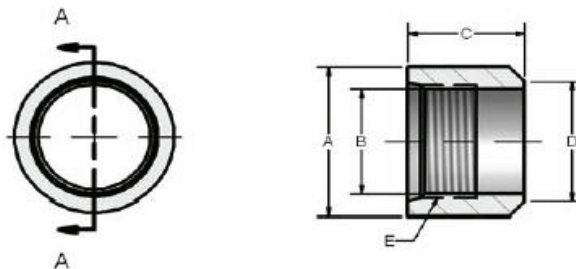

SAE HALF COUPLING BEVEL					
PART NO.	A	B	C	D	E SAE UN-2B
TR-835B-04	0.88	0.389	1.00	0.570	7/16-20*
TR-835B-06	1.00	0.508	1.00	0.690	9/16-18*
TR-835B-08	1.25	0.689	1.06	0.870	3/4-16*
TR-835B-10	1.38	0.806	1.06	0.990	7/8-14*
TR-835B-12	1.50	0.981	1.28	1.160	1 1/16-12
TR-835B-14	1.63	1.106	1.25	1.290	1 3/16-12
TR-835B-16	1.75	1.231	1.28	1.410	1 5/16-12
TR-835B-20	2.25	1.544	1.28	1.720	1 5/8-12
TR-835B-24	2.75	1.794	1.28	1.980	1 7/8-12
TR-835B-32	3.25	2.419	1.50	2.600	2 1/2-12

*UNF-2B

- AISI1020 Carbon Steel
- Includes individual thread identification marking
- Additional thread sizes and configurations available