

HEAVY SERIES CLAMP PARTS

HEAVY SERIES CLAMPS are available in a single heavy (SH) unit two (2) bolt design, or a double heavy (DH) unit four (4) bolt design. Clamps are designed to absorb shock and vibration and reduce noise from installations, such as: steel mills, power plants, ship building, off-highway equipment, off-shore drilling platforms, high pressure hydraulic machinery, etc. Heavy series clamps will accommodate pipes, tubes and hose ranging in size from ¼" to 8¾" O.D. Metric sizes available upon request. A basic clamp assembly consists of: a weld plate, two (2) identical clamp halves, a cover plate and two (2) hex head bolts. Weld and cover plates are made from low carbon steel material. **Stainless steel and plated hardware available for all groups.** Clamp halves are made of Polypropylene (PP) green or black colour, Santoprene (SP) tan colour, and Aluminum (AL) silver colour. Heavy series clamps of the same group may be stacked vertically to desired number by using stacking bolts (STB) and safety plates (SAF). **Plastic blanks for special bore diameters available in groups H3 thru H8.**

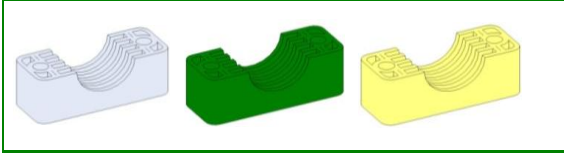

CLAMP INSERTS				
GROUP	SIZE	CLAMP OD	ORDER NO.	
H3	¼ T	0.250	H3064-PP	
	¾ T	0.375	H3095-PP	
	½ P	0.405	H3100-PP	
	½ T	0.500	H3127-PP	
	¼ P	0.540	H3137-PP	
	¾ T	0.625	H3160-PP	
H4	¾ P	0.675	H3171-PP	
	¾ T	0.750	H4190-PP	
	½ P	0.840	H4213-PP	
	¾ T	0.875	H4222-PP	
H5	1 T	1.000	H4254-PP	
	¾ P	1.050	H4267-PP	
	1¼ T	1.250	H5320-PP	
	1 P	1.315	H5334-PP	
H6	1½ T	1.500	H5381-PP	
	1¼ P	1.660	H5422-PP	
	1¼ P	1.660	H6422-PP	
	1¼ T	1.750	H6445-PP	
	1½ P	1.900	H6483-PP	
	2 T	2.000	H6508-PP	
	2¼ T	2.250	H6572-PP	
	2 P	2.375	H6603-PP	
	2½ T	2.500	H6635-PP	
	2¾ T	2.750	H6700-PP	
H7	2¾ T	2.750	H7700-PP	
	2½ P	2.875	H7730-PP	
	3 T	3.000	H7762-PP	
	3 P	3.500	H7889-PP	
H8	3½ T	3.500	H7889-PP	
	4 T	4.000	H8102-PP	
	4 P	4.500	H8114-PP	
	4½ T	4.500	H8114-PP	
H9	5 T	5.000	H8127-PP	
	5 T	5.000	H9127-PP	
	5¼ T	5.250	H9133-PP	
	5 P	5.563	H9141-PP	
	6 T	6.000	H9152-PP	
H10	6 P	6.625	H9168-PP	
	6 P	6.625	H10168-PP	
H10	8 T	8.000	H1010203-PP	
	8 P	8.625	H1010219-PP	

2 BOLT SINGLE HEAVY COVER PLATE	2 BOLT SINGLE WELD PLATE	4 BOLT DOUBLE HEAVY COVER PLATE
HCP-3 HCP-4 HCP-5 HCP-6 HCP-7 HCP-8 HCP-9 HCP-10	HWP-3 HWP-4 HWP-5 HWP-6 HWP-7 HWP-8 HWP-9 HWP-10	HDCP-3 HDCP-4 HDCP-5 HDCP-6 HDCP-7 HDCP-8 HDCP-9 HDCP-10

4 BOLT DOUBLE WELD PLATE	HEX BOLT	STACKING BOLT
HDWP-3 HDWP-4 HDWP-5 HDWP-6 HDWP-7 HDWP-8 HDWP-9 HDWP-10	HEX-H3 HEX-H4 HEX-H5 HEX-H6 HEX-H7 HEX-H8 HEX-H9 HEX-H10	HSB-3 HSB-4 HSB-5 HSB-6 HSB-7 HSB-8 HSB-9 HSB-10

Two pieces req'd per assembly *Two pieces req'd per assembly*

SAFETY PLATE	RAIL NUT	MOUNTING RAIL
HSP-3 HSP-4 HSP-5 HSP-6 HSP-7 HSP-8 HSP-9 HSP-10	HRN-3-5 <i>Group H3 - H5</i> HRN-6 <i>Group H6</i>	HR-6'-2M <i>For use with rail nuts</i> <i>Standard length = 2 Meters</i>

Two pieces req'd per assembly



USA Tel: 716-283-8780
Fax: 716-283-8781



Canada Tel: 905-545-2038
Fax: 905-545-0528

Email: wbisson@trilexfluidpower.com
Web: trilexfluidpower.com