

BKH/SKH SERIES HIGH PRESSURE 2-WAY BALL VALVES - STEEL

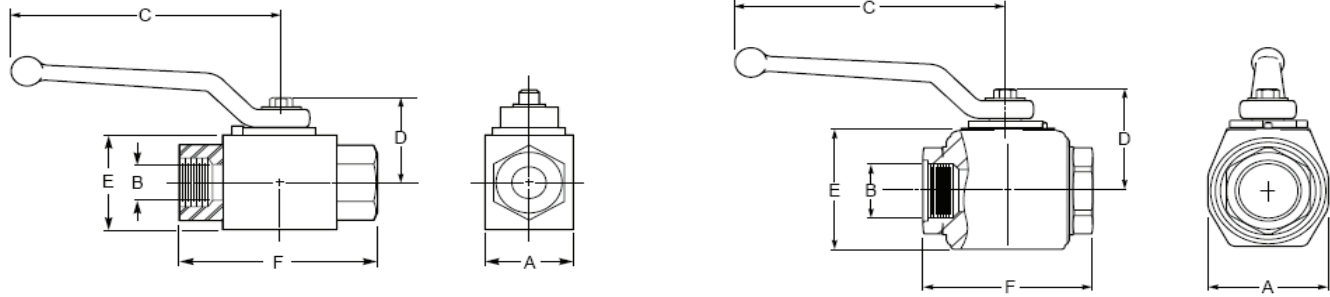

PART NUMBER	NOMINAL SIZE	THREAD	WORKING PRESSURE	INCH DIMENSIONS					
				A	B	C	D	E	F
BKH-14-NPT-1125	1/4"	1/4" NPT F	7350 PSI						
BKH-14-BSP-1125	1/4"	1/4" BSP P	7350 PSI	1.02	.24	4.21	1.20	1.26	2.72
BKH-14-SAE-1125	1/4"	7/16-20 UNF	7350 PSI						
BKH-38-NPT-1125	3/8"	3/8" NPT F	7350 PSI						
BKH-38-BSP-1125	3/8"	3/8" BSP P	7350 PSI	1.26	.39	4.21	1.29	1.50	2.87
BKH-38-SAE-1125	3/8"	9/16-18 UNF	7350 PSI						
BKH-12-NPT-1125	1/2"	1/2" NPT F	7350 PSI						
BKH-12-BSP-1125	1/2"	1/2" BSP P	7350 PSI	1.38	.51	4.21	1.31	1.57	3.62
BKH-12-SAE-1125	1/2"	3/4-16 UNF	7350 PSI						
BKH-34-NPT-1125	3/4"	3/4" NPT F	5880 PSI						
BKH-34-BSP-1125	3/4"	3/4" BSP P	5880 PSI	1.93	.79	6.50	1.91	2.24	3.82
BKH-34-SAE-1125	3/4"	1 1/16-12 UNF	5880 PSI						
BKH-1-NPT-1125	1"	1" NPT F	5145 PSI						
BKH-1-BSP-1125	1"	1" BSP P	5145 PSI	2.36	.94	6.50	1.95	2.36	4.45
BKH-1-SAE-1125	1"	1 5/16-12 UNF	5145 PSI						
* BKH-114-NPT-1125	1"	1 1/4" NPT F	5145 PSI						
* BKH-114-BSP-1125	1"	1 1/4" BSP P	5145 PSI	2.36	.94	6.50	1.95	2.36	5.16
* BKH-114-SAE-1125	1"	1 5/8-12 UNF	5145 PSI						
* BKH-112-NPT-1125	1"	1 1/2" NPT F	5145 PSI						
* BKH-112-BSP-1125	1"	1 1/2" BSP P	5145 PSI	2.36	.94	6.50	1.95	2.36	5.47
* BKH-112-SAE-1125	1"	1 7/8-12 UNF	5145 PSI						
SKH-114-NPT-3125	1 1/4"	1 1/4" NPT F	6175 PSI						
SKH-114-BSP-3125	1 1/4"	1 1/4" BSP P	6175 PSI	2.99	1.26	8.30	2.60	3.30	4.50
SKH-114-SAE-3125	1 1/4"	1 5/8-12 UNF	6175 PSI						
SKH-112-NPT-3125	1 1/2"	1 1/2" NPT F	6175 PSI						
SKH-112-BSP-3125	1 1/2"	1 1/2" BSP P	6175 PSI	3.27	1.50	8.30	2.73	3.62	5.30
SKH-112-SAE-3125	1 1/2"	1 7/8-12 UNF	6175 PSI						
SKH-2-NPT-3125	2"	2" NPT F	6175 PSI						
SKH-2-BSP-3125	2"	2" BSP P	6175 PSI	3.94	1.89	8.50	3.15	4.37	5.50
SKH-2-SAE-3125	2"	2 1/2-12 UNF	6175 PSI						

CONSTRUCTION: STEEL BODY, BALL AND STEM
 VITON® "O" RINGS
 DELRIN® BALL SEATS
 FULL PORT

*REDUCED TO 1" PORT

SIDE OR TOP DRILLED AND TAPPED MOUNTING HOLES AVAILABLE. CONTACT PCI FOR A TECHNICAL DRAWING.
 AVAILABLE FOR BKH/SKH AND BK3/SK3 SERIES.
 HIGHER PRESSURE FULL PORT BALL VALVES RANGING FROM 6175 PSI TO 8820 PSI IN SIZES 1/4"-1" ARE AVAILABLE WITH A FORGED STEEL BODY. CONTACT PCI FOR DETAILS.