

Pressure application only with connected flanges.

AVAILABLE SIZES

DN13 - DN50 (1/2" to 2")

CONNECTIONS

ISO 6162-1 , ISO 6162-2

ACCESSORIES ON REQUEST

- Locking devices on request
- Actuator on request
- Mounting holes on request
- Positions switches on request
- Combinations on request
- Detent on request

MATERIAL CODE DESCRIPTION

Materials	112A	1128	
Body	Steel	Steel	
Ball	Steel	Steel	
Stem	Steel	Steel	
Ball Seats	POM	POM	
O-Rings	NBR	FPM	
Tmin / Tmax	-10°C / 100°C	-10°C / 100°C	

GENERAL DIMENSIONS

TYPE	LW	D	L	I	H	h	m	K	SW	V	H ₂	Lever	Weight (Kg)
KHZ-DN13	13	13	68	34	72	58	30	115	9	11	109	St	1,8
KHZ-DN20	20	20	70	35	93	75	37,5	171	14	14	146	St	2,8
KHZ-DN25	25	25	78	39	103	84,5	44	171	14	14	155	St	3,9
KHZ-DN32	25	32	90	45	119	100	50	171	14	14	171	St	6,5
KHZ-DN40	32	38	99	49,5	141	120	60	306	17	17	214	St	10,5
KHZ-DN50	38	49	120	60	158,5	137,5	70	306	17	17	232	St	16,5

These intermediate ball valves have been designed with both bore patterns in accordance with ISO 6162-1 or ISO 6162-2. They can either be flanged on one side to a hydraulic block and connected on the other side with a hydraulic pipe, or they can be installed into a pipe system. Please note the pressure ratings of the connection flanges!

CONNECTION TYPE

ISO 6162-1

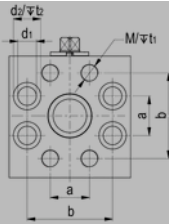

DIMENSIONS

TYPE	a	b	M	t ₁	d ₁	d ₂	t ₂	S1 ⁽¹⁾ Dimension of screws (min)	S2 ⁽¹⁾ Dimension of screws (min)	O-ring
KHZ-DN13-SAE210	18,2	40,5	M8	15	8,5	13,5	9	M8x30-10.9	M8x70-10.9	18,64x3,53
KHZ-DN20-SAE210	23,8	50,8	M10	17	10,5	16,5	11	M10x35-12.9	M10x80-12.9	24,99x3,53
KHZ-DN25-SAE210	27,8	57,2	M12	21	13	19	13	M12x45-10.9	M12x80-10.9	32,92x3,53
KHZ-DN32-SAE210	31,8	66,7	M12	20	13	19	13	M12x45-10.9	M12x80-10.9	37,69x3,53
KHZ-DN40-SAE210	36,5	79,4	M16	27	17	25	17,5	M16x55-10.9	M16x100-10.9	47,22x3,53
KHZ-DN50-SAE210	44,5	96,8	M20	34	21	31	21,5	M20x70-10.9	M20x130-10.9	56,74x3,53
KHZ-DN13-SAE210	18,2	40,5	5/16"UNC	15	8,5	13,5	9	5/16"UNCx30-10.9	5/16"UNCx70-10.9	18,64x3,53
KHZ-DN20-SAE210	23,8	50,8	3/8"UNC	17	10,5	16,5	11	3/8"UNCx35-12.9	3/8"UNCx80-12.9	24,99x3,53
KHZ-DN25-SAE210	27,8	57,2	7/16"UNC	21	13	19	13	7/16"UNCx45-10.9	7/16"UNCx80-10.9	32,92x3,53
KHZ-DN32-SAE210	31,8	66,7	1/2"UNC	20	13	19	13	1/2"UNCx45-10.9	1/2"UNCx90-10.9	37,69x3,53
KHZ-DN40-SAE210	36,5	79,4	5/8"UNC	26	17	25	17,5	5/8"UNCx55-10.9	5/8"UNCx100-10.9	47,22x3,53
KHZ-DN50-SAE210	44,5	96,8	3/4"UNC	34	21	31	21,5	3/4"UNCx70-10.9	3/4"UNCx130-10.9	56,74x3,53

ORDER CODE PER MATERIAL

PN (bar)	112A	1128
420	47116	47124
420	47117	41631
420	47118	47125
420	47119	47126
420	47120	47127
420	47121	47128
420	47131	47137
420	41643	41716
420	47145	47143
420	47132	47138
420	47133	47139
420	47134	47140

CONNECTION TYPE

ISO 6162-2

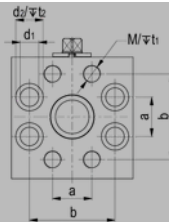

DIMENSIONS

TYPE	a	b	M	t ₁	d ₁	d ₂	t ₂	S1 ⁽¹⁾ Dimension of screws (min)	S2 ⁽¹⁾ Dimension of screws (min)	O-ring
KHZ-DN13-SAE420	18,2	40,5	M8	15	8,5	13,5	9	M8x30-10.9	M8x70-10.9	18,64x3,53
KHZ-DN20-SAE420	23,8	50,8	M10	17	10,5	16,5	11	M10x35-12.9	M10x80-12.9	24,99x3,53
KHZ-DN25-SAE420	27,8	57,2	M12	21	13	19	13	M12x45-10.9	M12x80-10.9	32,92x3,53
KHZ-DN32-SAE420	31,8	66,7	M12	20	13	19	13	M12x45-10.9	M12x80-10.9	37,69x3,53
KHZ-DN40-SAE420	36,5	79,4	M16	27	17	25	17,5	M16x55-10.9	M16x100-10.9	47,22x3,53
KHZ-DN50-SAE420	44,5	96,8	M20	34	21	31	21,5	M20x70-10.9	M20x130-10.9	56,74x3,53
KHZ-DN13-SAE420	18,2	40,5	5/16"UNC	15	8,5	13,5	9	5/16"UNCx30-10.9	5/16"UNCx70-10.9	18,64x3,53
KHZ-DN20-SAE420	23,8	50,8	3/8"UNC	17	10,5	16,5	11	3/8"UNCx35-12.9	3/8"UNCx80-12.9	24,99x3,53
KHZ-DN25-SAE420	27,8	57,2	7/16"UNC	21	13	19	13	7/16"UNCx45-10.9	7/16"UNCx80-10.9	32,92x3,53
KHZ-DN32-SAE420	31,8	66,7	1/2"UNC	20	13	19	13	1/2"UNCx45-10.9	1/2"UNCx90-10.9	37,69x3,53
KHZ-DN40-SAE420	36,5	79,4	5/8"UNC	26	17	25	17,5	5/8"UNCx55-10.9	5/8"UNCx100-10.9	47,22x3,53
KHZ-DN50-SAE420	44,5	96,8	3/4"UNC	34	21	31	21,5	3/4"UNCx70-10.9	3/4"UNCx130-10.9	56,74x3,53

ORDER CODE PER MATERIAL

PN (bar)	112A	1128
420	47116	47124
420	47117	41631
420	47118	47125
420	47119	47126
420	47120	47127
420	47121	47128
420	47131	47137
420	41643	41716
420	47145	47143
420	47132	47138
420	47133	47139
420	47134	47140

⁽¹⁾ Screws and flanges not included